

FL LED Indicator

Bright, Soft lighting LED indicator.

50 × 100mm, Outstanding visibility.

FEATURES

- Size : 50 × 100mm rectangular type
- Depth behind panel : 29.5mm
- Mounting : Snap-in type
- Terminal : Connector type
- Illumination : Mono-Color, Split-Face, Dual-Color, Negative



SPECIFICATIONS

Insulation Resistance	More than 100M Ω at 500V DC
Dielectric Strength	1500V AC RMS between terminals and ground (50/60Hz for 1 minute)
Reverse Dielectric Strength	400V
Ambient Temperature	-10 $^{\circ}$ C~40 $^{\circ}$ C
Ambient Humidity	45~85%RH

LED DATA

DC Supply Voltage		Current Rating (mA)		
		Red	Green	Yellow
DC24V (\pm 5%)	Full-Face	38	74	74
	Split-Face (Vert.)	19	37	37
	Split-Face (Horiz.)	19	37	37
	Dual-Color	23	56	61

※Reverse breakdown voltage is 150V.

DC Supply Voltage		Current Rating (mA)		
		Red	Green	Yellow
DC48V (\pm 5%)	Full-Face	19	37	37
	Split-Face(Vert.)	10	19	19
	Split-Face(Horiz.)	10	19	19
	Dual-Color	12	28	32

STRUCTURE

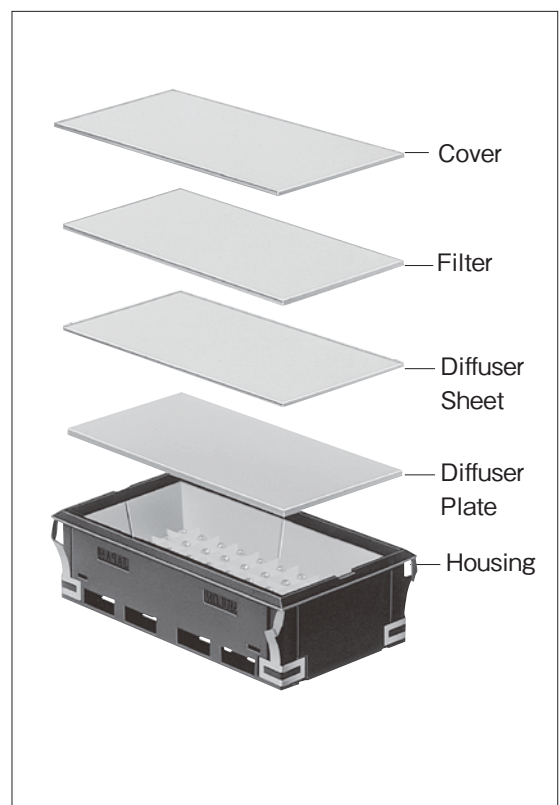

DIMENSIONS

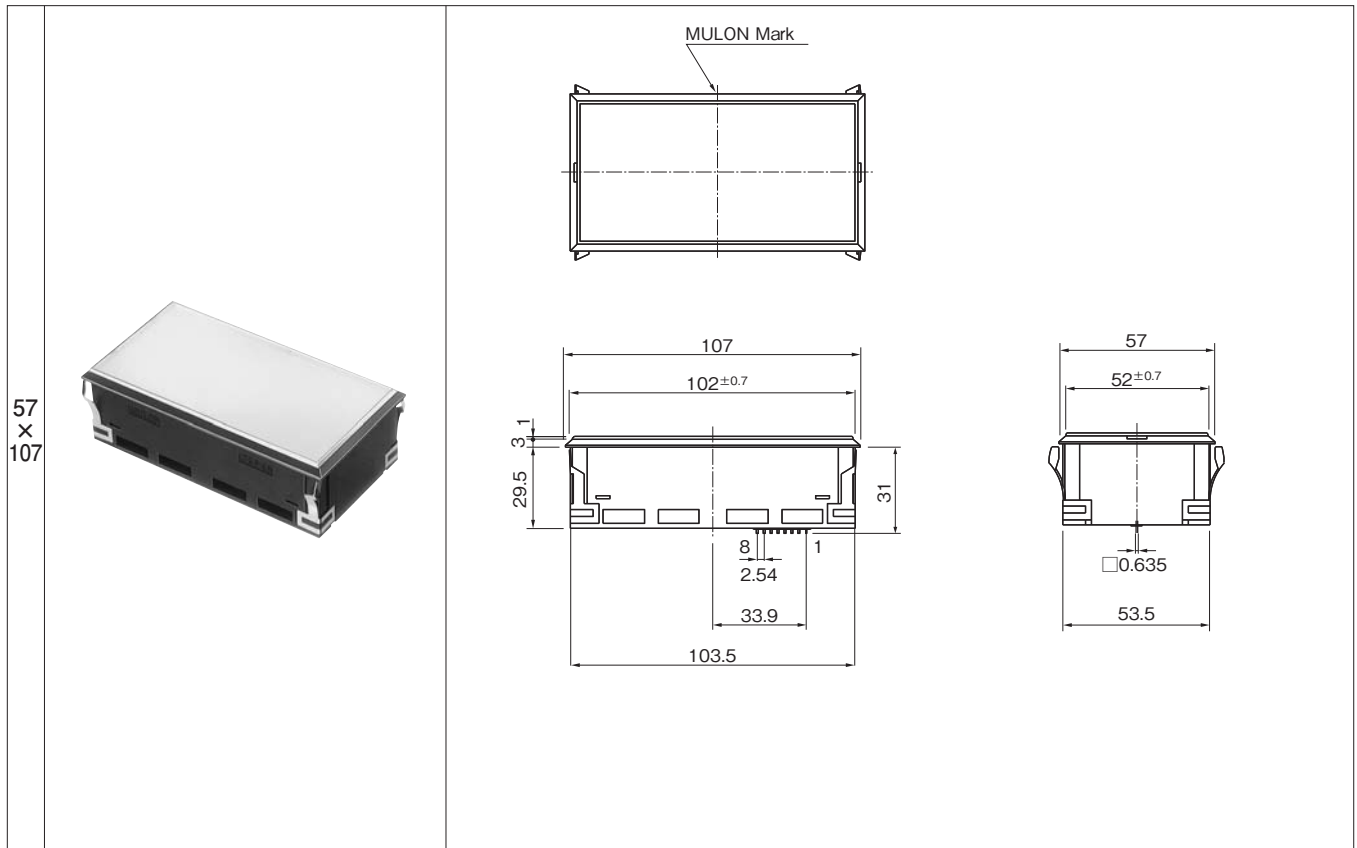

INTERNAL CONNECTION ARRANGEMENTS

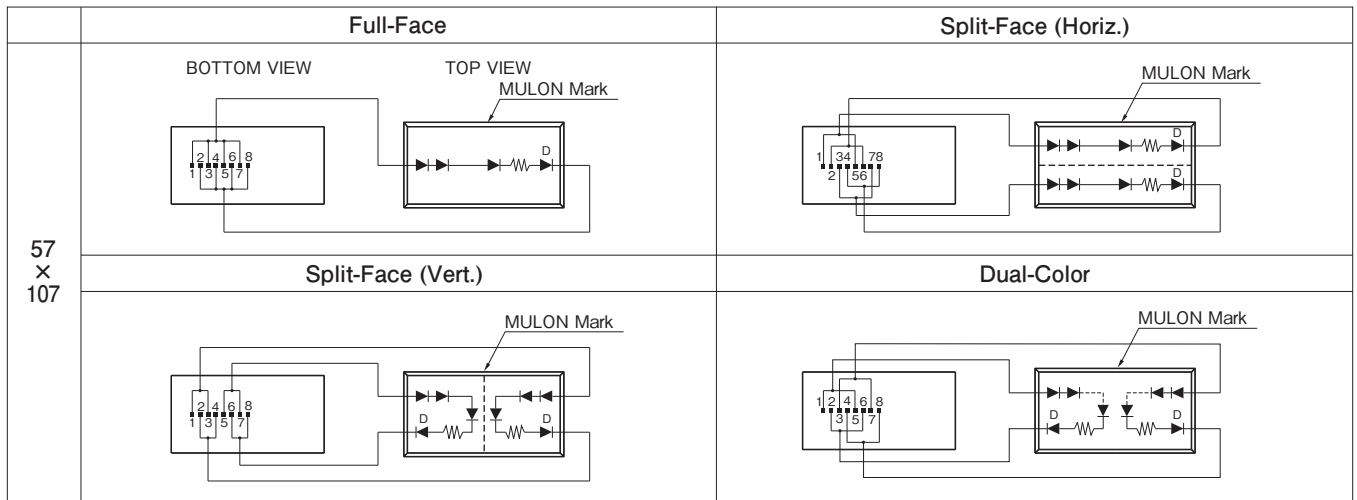

●Dual-Color combination

Terminals	LED Color	
3.7-4.8	Red	Red
1.5-2.6	Green	Yellow

Tolerance : ±0.4mm

端子配置

● TERMINAL LAYOUT

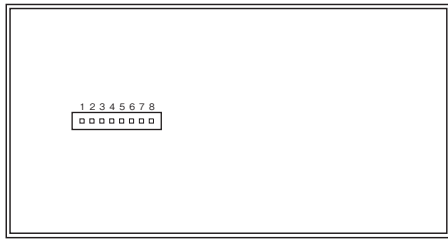

● Suitable wire

Wire size	Diameter
AWG#24-28	1.0-1.5mm

Pin No.	57×107			
	Full-Face	Dual-Color	Split, Horiz.	Split, Vert.
1	Anode (+)	Anode (+)	Anode (+)	Anode (+)
2	Cathode (-)	Cathode (-)	Cathode (-)	Cathode (-)
3	Anode (+)	Anode (+)	Anode (+)	Anode (+)
4	Cathode (-)	Cathode (-)	Cathode (-)	Cathode (-)
5	Anode (+)	Anode (+)	Anode (+)	Anode (+)
6	Cathode (-)	Cathode (-)	Cathode (-)	Cathode (-)
7	Anode (+)	Anode (+)	Anode (+)	Anode (+)
8	Cathode (-)	Cathode (-)	Cathode (-)	Cathode (-)

PANEL LAYOUT / PANEL CUT DIMENSIONS

Panel thickness : 1mm~5mm

	Panel Layout	Panel Cut Dimensions
57 x 107 Vert. Serial		
57 x 107 Horiz. Serial		

Panel cut dimension should be after panel paintings.

n: number of indicators

ACCESSORIES

Wire Harness

Wire : UL-1061, AWG26

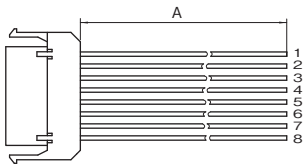

A Length	Part No.
50cm	FL-0791-1

Connector Holder

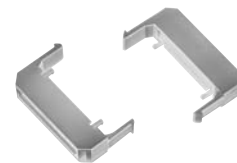

Part No. FL-0016

Pin No.	1	2	3	4	5	6	7	8
Color	Orange	Blue	Green	Red	Yellow	Black	Gray	Brown

記名板寸法

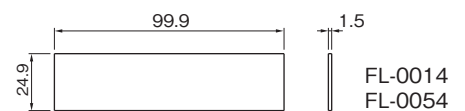
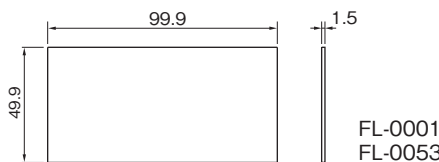
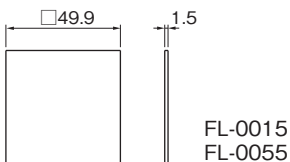

Tolerance : ±0.4mm

ACCESSORIES

● FILTER

	Red	Green	Yellow	Clear	Negative Red	Negative Green	Negative Yellow	Negative Clear
Full-Face	FL-0001-R	FL-0001-G	FL-0001-Y	FL-0001-C	FL-0053-R	FL-0053-G	FL-0053-Y	FL-0053-C
Split(Horiz.)	FL-0014-R	FL-0014-G	FL-0014-Y	FL-0014-C	FL-0054-R	FL-0054-G	FL-0054-Y	FL-0054-C
Split(Vert.)	FL-0015-R	FL-0015-G	FL-0015-Y	FL-0015-C	FL-0055-R	FL-0055-G	FL-0055-Y	FL-0055-C

● COVER

Item	Clear	Negative
Part No.	FL-0007-C	FL-0007-SK

● Diffuser Plate

Part No.
FL-0009

● DIVIDER

Item	Split (Vert.)	Split (Horiz.)
Part No.	FL-1267	FL-1268

ORDERING CODE

FL — [] [1][2] [] [] [1][2] [] [] []

● SHAPE & ILLUMINATION

W0	Full-Face	W2	Split, Horiz.
W1	Split, Vert.	W3	Dual-Color

● LED COLOR

70	Red	Full-Face : Put color no. into the frame 1 Split-Face : Put color no. into the frame 1, 2 Dual-Color : Put color no. into the frame 1, 2 (Dual-Color Combination 7080 or 9070)
80	Green	
90	Yellow	
X	Without LED	

● COVER

C	Transparent
SK	Semitransparent (for Negative)
X	Without Cover

● HOUSING COLOR

K	Black
H	Gray

● MOUNTING

1	For Horiz. Mtg.
2	For Vert. Mtg.
X	Without Snap spring

● SUPPLY VOLTAGE

3	24V
5	48V
X	Without LED

● TERMINAL

K	Connector
---	-----------

● FILTER COLOR

1	Red	Full-Face : Put color no. into the frame 1 Split-Face : Put color no. into the frame 1, 2 Dual-Color : Put color no. 9 into the frame 1
2	Green	
3	Yellow	
9	Clear	
X	Without Filter	

● NOTES

- 1) In case of Split-Face, LED and filter color location should be specified as follow.

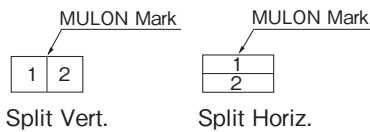

- 2) In case of specify a cover for Negative, the filter is black silk printed on one side.
- 3) Simultaneous lighting is possible for Split-Face and DUal-Color.
- 4) Snap-spring metal plates come out Left/Right direction for Vertical mounting, and Top/Bottom direction for Horizontal mounting to avoid interfering mutually in case of serial mounting. Therefore, in case of independent use, it does not matter. (select 1 Horizontal ordinary)